

# CHANCERY COURT AUCTION

**September 28, 2024 at 10:30 a.m.  
on the premises at 3341 Page Street**

Information about the property being sold<sup>1</sup>:

1. The Property address is: 3341 Page Street, Kingsport, TN
2. The Tax ID Nos. are: 014N/E/016.00
3. For further legal description see Deed Book 370C Page 567
4. The tax appraised value for the parcel is \$69,600.00

Terms and Conditions of the Auction:

1. **Property is sold in “as is, where is” condition**
2. **Property is sold subject to Court approval**
3. Property will be sold to the highest bidder with 10% of the bid amount due immediately after the auction
4. The balance of the bid amount is due within 30 days
5. There is no minimum bid/reserve bid, however, the final bid must be approved by the Court
6. The 10% bid amount is only refundable if the court does not approve the sales price or the Court cannot deliver marketable title
7. **The sale of the property is NOT conditioned upon the buyer obtaining a loan**
8. You may pay the 10% with cashier's check or personal check on the day of the auction
9. **The property will be open for inspection the day of the sale, September 28, 2024 at 9:00 a.m.**
10. Announcements made the day of sale take precedence over any printed announcements

**For additional information you may contact the Special Commissioner/Clerk and Master,  
Katharine Jennelle, at (423) 323-6485**

***Disclaimer:*** This property is being sold “as is, where is, as inspected, day of auction”. Neither the Seller nor the Court or Special Commissioner guarantees the accuracy or credibility of pre-auction information. Prospective purchasers are required to perform due diligence prior to bidding at the auction.

---

<sup>1</sup> All information pertaining to the property has been obtained from the Tennessee Real Estate Assessment Data website at [www.assessment.cot.tn.gov](http://www.assessment.cot.tn.gov)

# Sullivan County - Parcel: 014N E 016.00

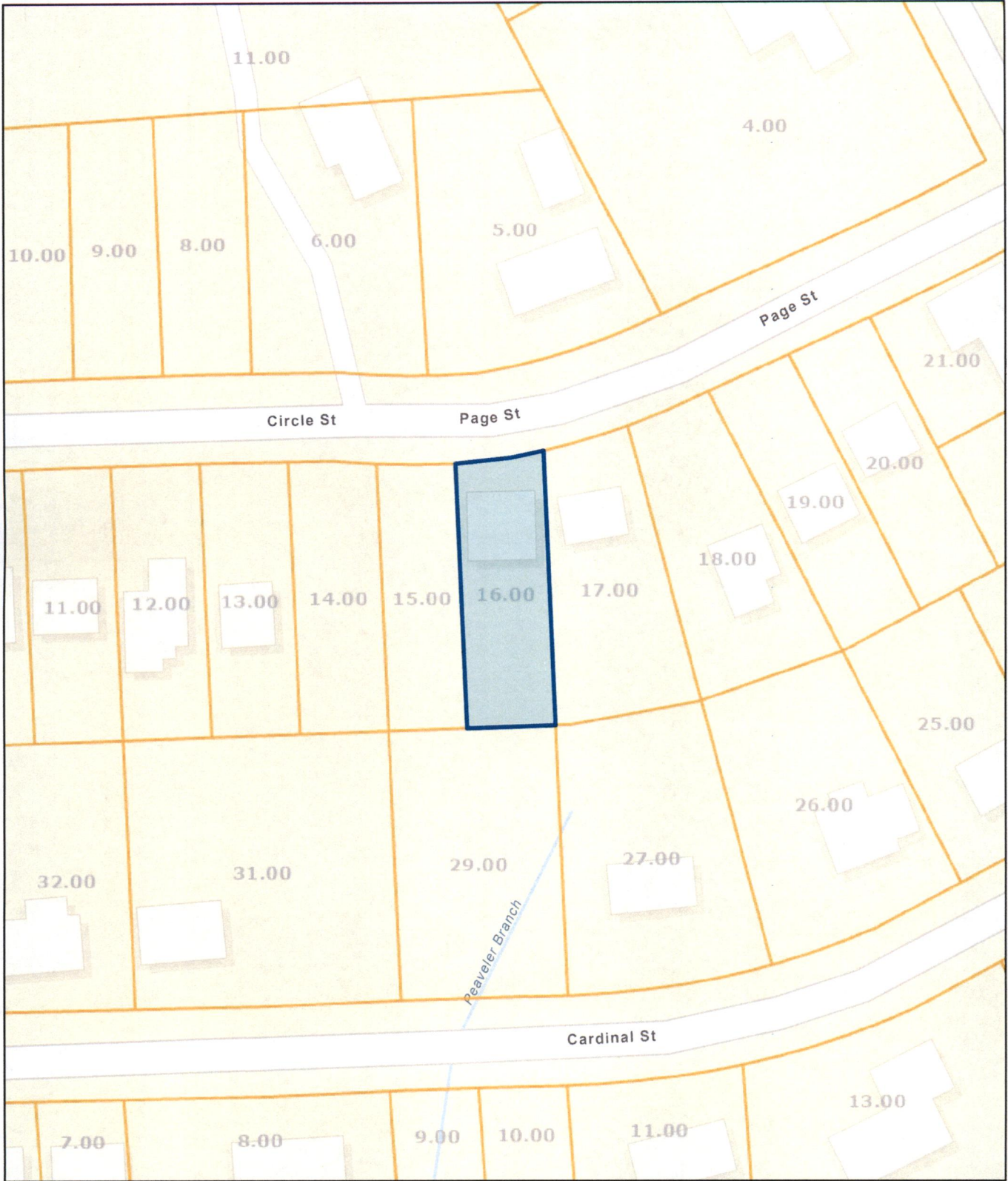

Date: September 6, 2024

County: Sullivan  
Owner: POWERS JAMES N &  
Address: PAGE ST 3341  
Parcel Number: 014N E 016.00  
Deeded Acreage: 0  
Calculated Acreage: 0.17  
Date of TDOT Imagery: 2019  
Date of Vexcel Imagery: 2023

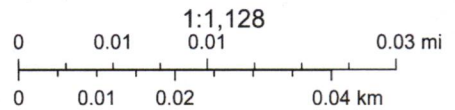

State of Tennessee, Comptroller of the Treasury, Division of Property Assessments (DPA), Esri Community Maps Contributors, Tennessee STS GIS, VGIN, © OpenStreetMap, Microsoft, Esri, TomTom, Garmin, SafeGraph, GeoTechnologies, Inc, MET/NASA, USGS, EPA, NPS, US Census Bureau, USDA, USFWS

The property lines are compiled from information maintained by your local county Assessor's office but are not conclusive evidence of property ownership in any court of law.